

Fitting panels to steel posts

Longer pins can be supplied in order that they go through the posts – see drawing below

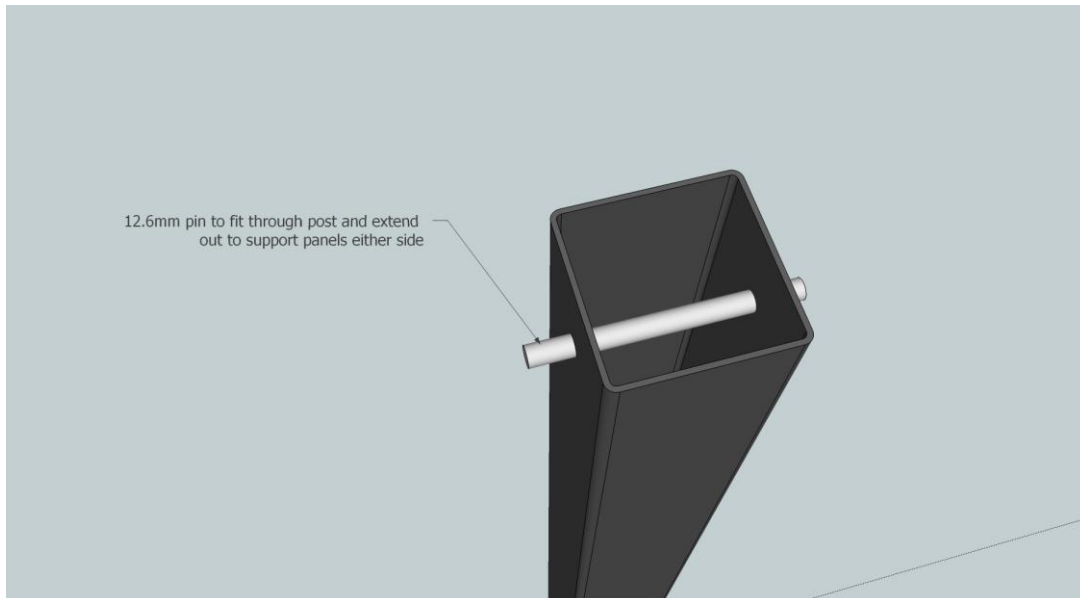

Where pins cannot extend all the way through, it is preferable to drill holes slightly under the pin diameter (12.5mm is ideal), and then the pin will hammer in and hold. If the pin cannot be held firmly in the hole, then a little epoxy adhesive, or tack weld where shown can suffice.

